

NOTE:
 TEMPORARY PEDESTRIAN CROSSING TO BE PROVIDED FOR THE DURATION OF CONSTRUCTION

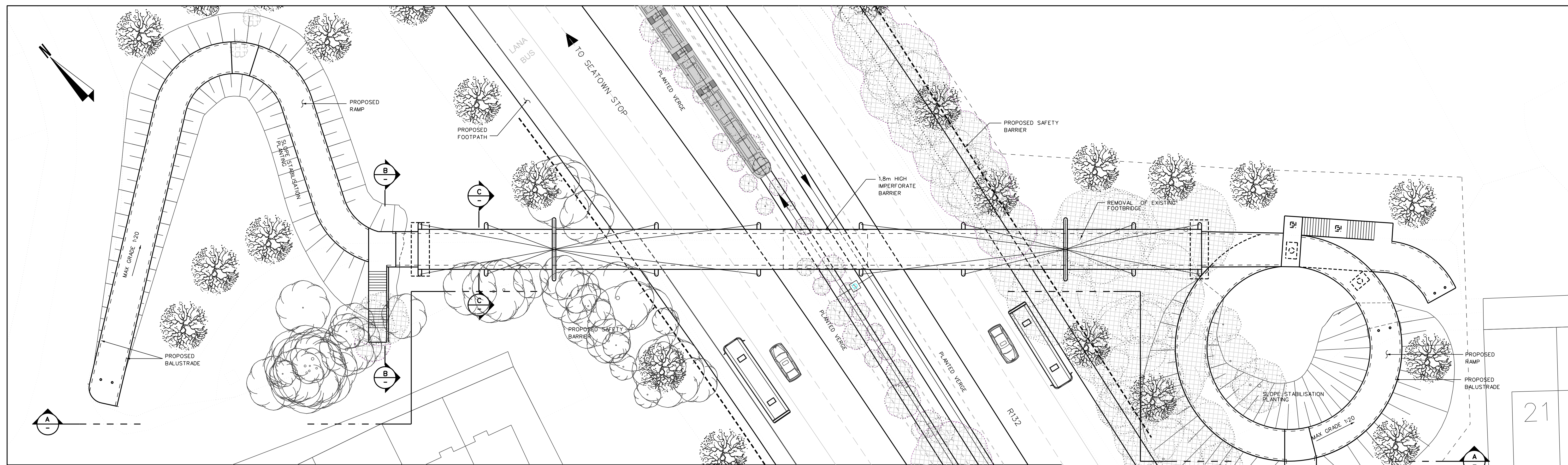

PLAN OF FOOTBRIDGE
 SCALE 1:200

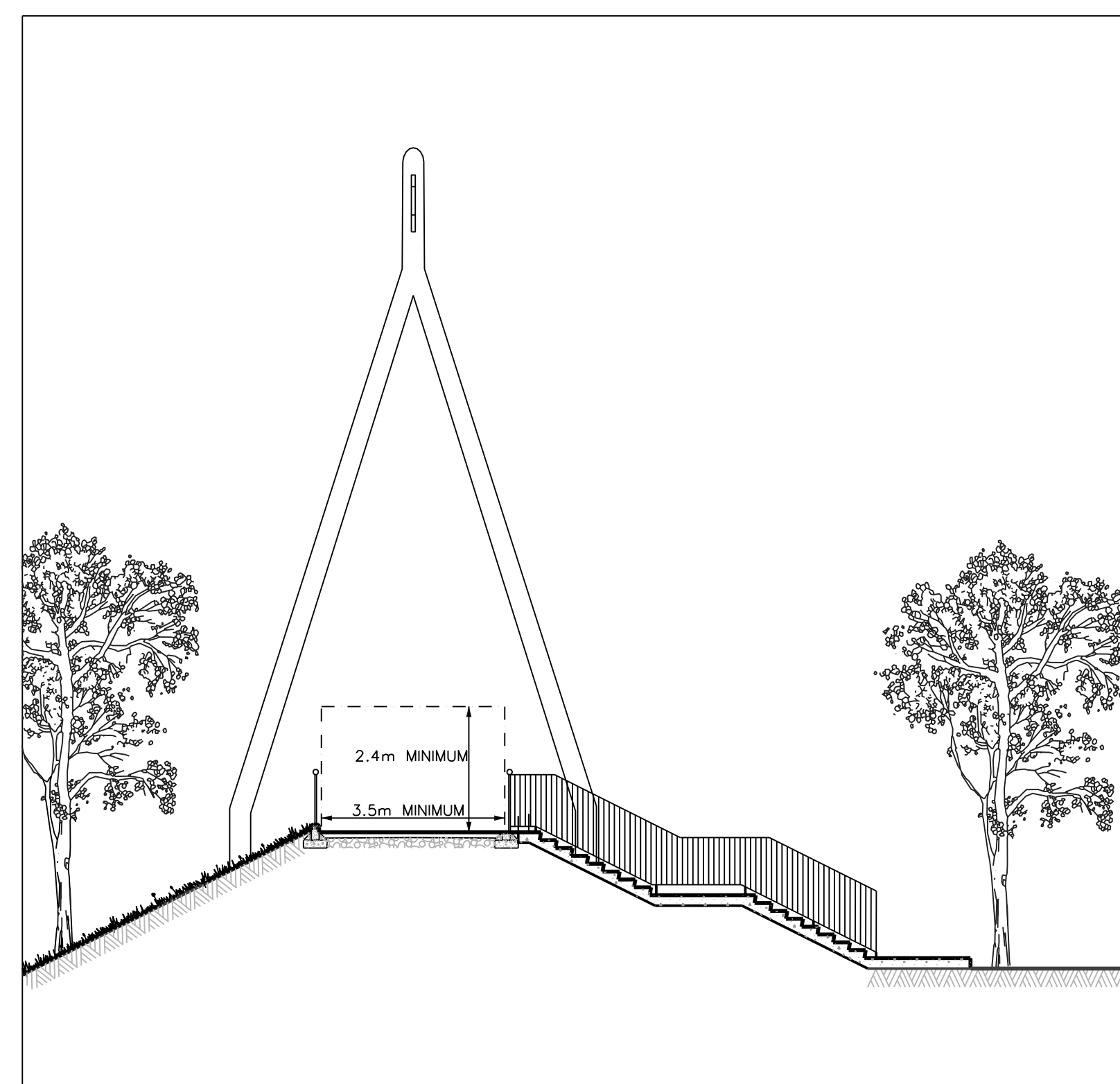

SECTION B-B
 SCALE 1:100

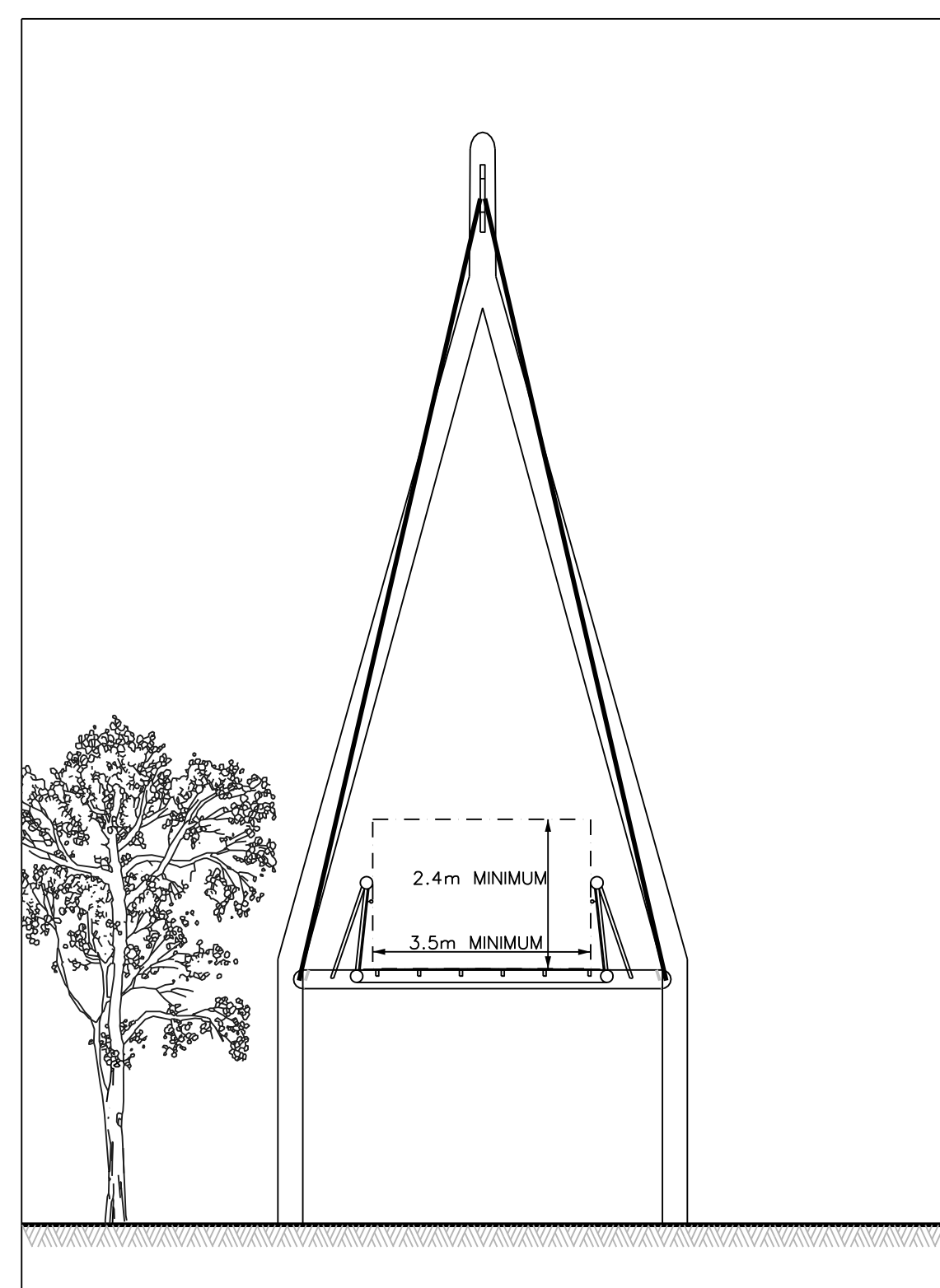

SECTION C-C
 SCALE 1:100

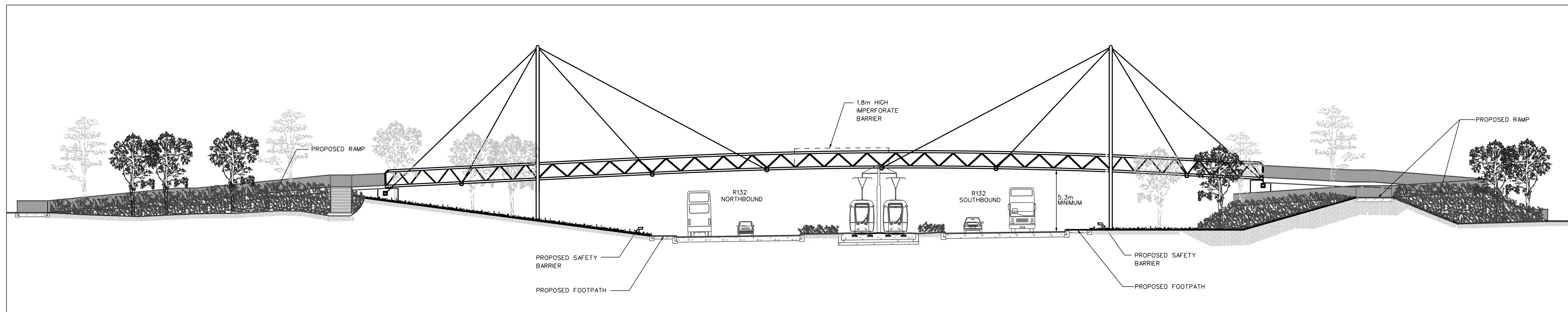
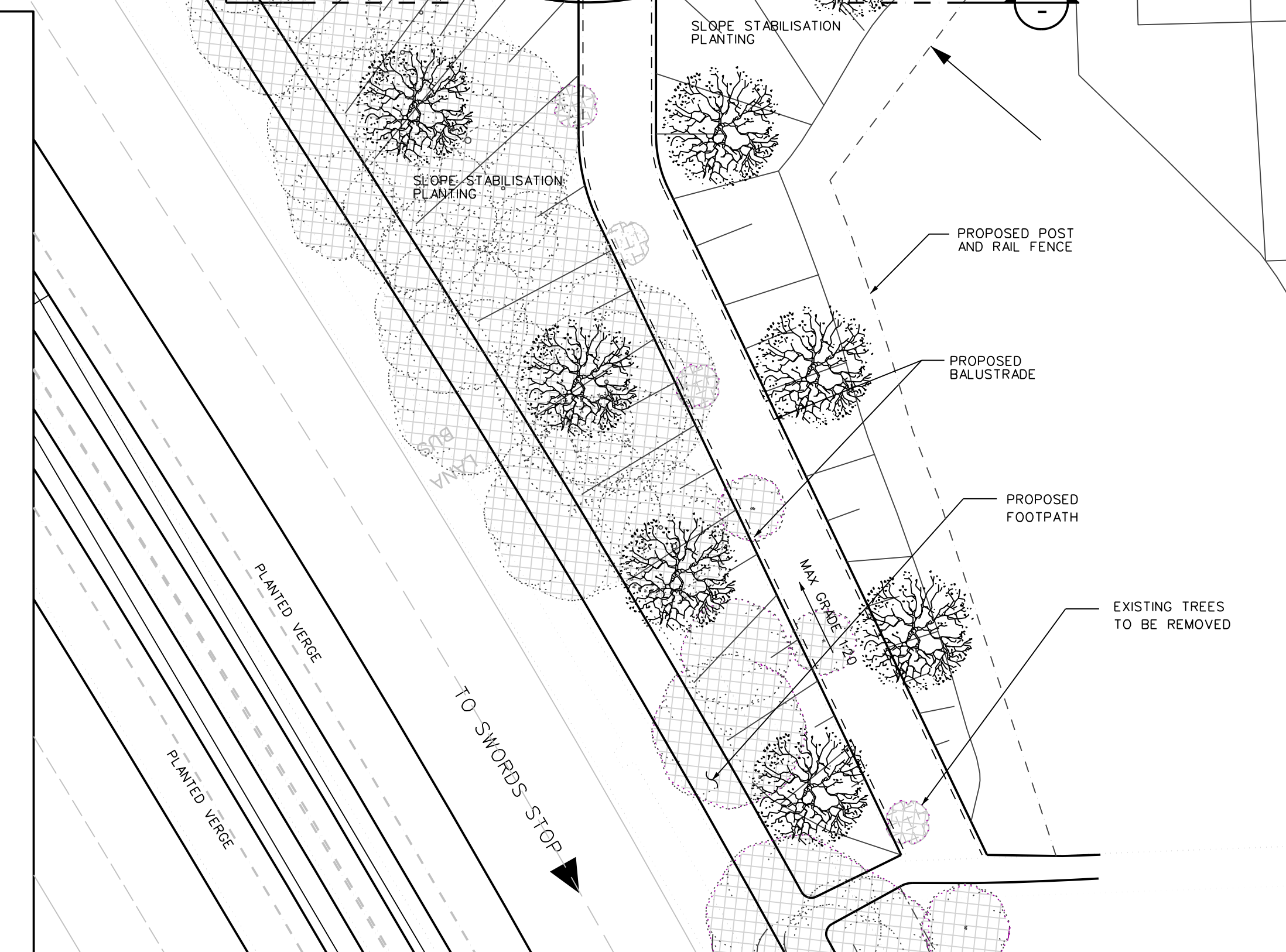

SECTIONAL ELEVATION A-A
 SCALE 1:200

REFERENCE RELATED DRAWINGS
 FOR 1:500 PLAN DRAWING SEE
 RAIL ORDER PLAN No.
 MN-RO 101 J-K
 (L/MN/000/GA/101010/A)

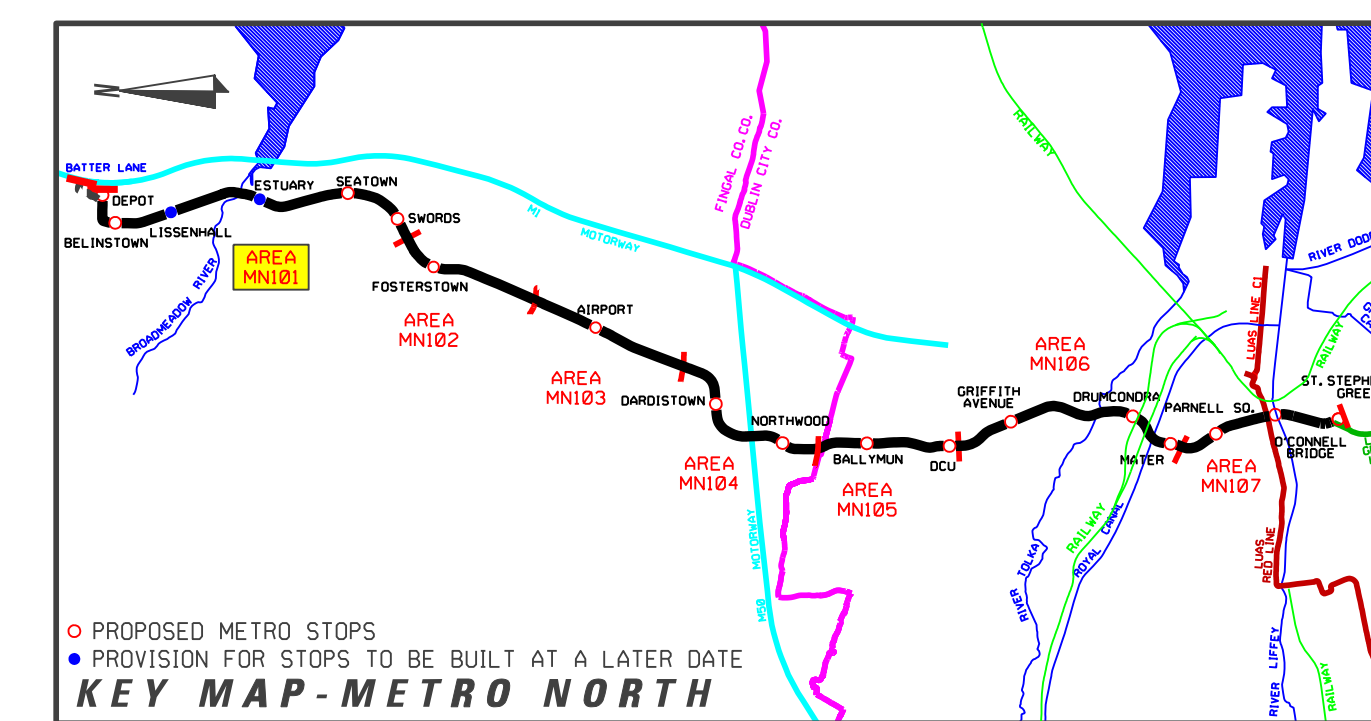

REVISION	DATE	MODIFICATION	STATUS	CHECKED/APPROVED



RPA
 Railway Procurement Agency



METRO

TITLE:
RAILWAY WORKS
 LINE MN - STRUCTURES
CHAPEL LANE FOOTBRIDGE REPLACEMENT

PREPARED: RPA OFFICE	CHECKED: GEOFFREY FEATHERSTONE
SCALE: 1:200, 1:100	APPROVED: ROBY O'CONNOR
DATE: AUGUST 2008	

AREA NO. 101	PLAN NO. MN-BR 101 J-K	SUBJECT: RAIL ORDER
------------------------	----------------------------------	-------------------------------

Copyright Railway Procurement Agency
 This drawing is confidential and the copyright in it is owned by the RPA. This drawing must not be either issued,
 copied or otherwise reproduced in whole or in part or used for any purpose without the prior permission of the RPA.
 All U.S. data used for plans is generated from U.S. digital maps and are printed under Ordnance Survey permit no. 05-8817

INTERNAL DOCUMENT NUMBER	STAGE	LINE	CONTRACT	ELEMENT	OPW NO.	OPW REV.
	L	MN	000	BS	101009	A